

TYPE #1

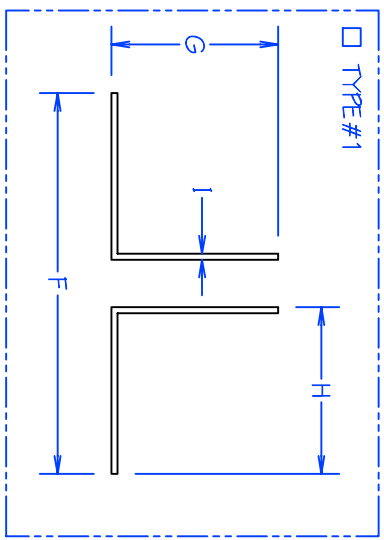

TYPE #2

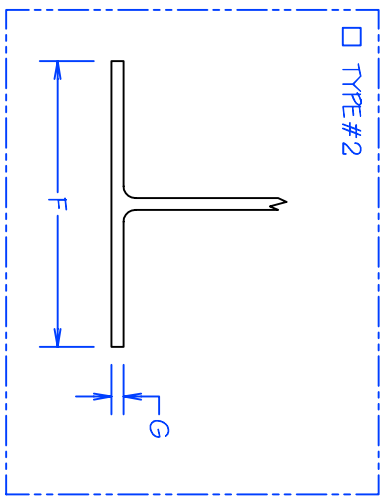

TYPE #3

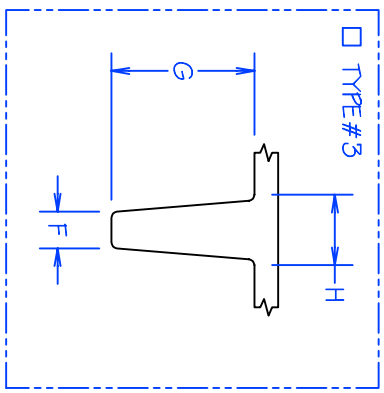

TYPE #4

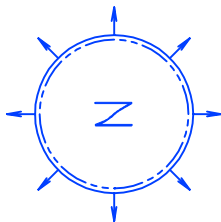
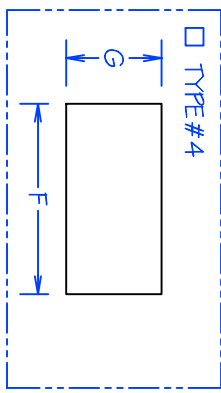

LOCATE AND PROVIDE DIMENSIONS FOR ANY OBJECTS (CEILING, LIGHTS, DUCT WORK, BLEACHERS, ETC.) WHICH MAY INTERFERE WITH BACKSTOP INSTALLATION OR OPERATION. IF NO NOTES ARE MADE ACF WILL ASSUME THAT THERE WILL BE NO OBJECTS WHICH INTERFERE WITH THE BASKETBALL BACKSTOP ASSEMBLY. IF A SPECIAL SUPPORT STRUCTURE IS TO BE PROVIDED FOR BACKSTOP, PROVIDE A DETAIL AND DIMENSIONS.

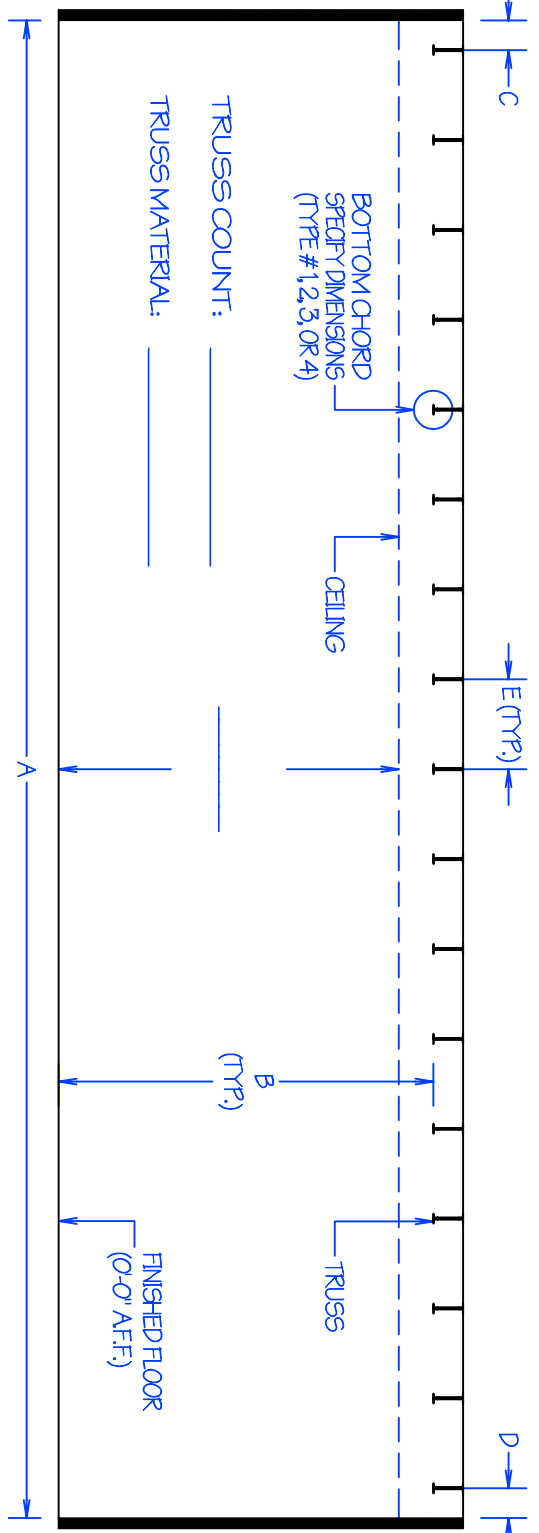

TRUSS COUNT: _____
 TRUSS MATERIAL: _____

BOTTOM CHORD
 SPECIFY DIMENSIONS
 (TYPE #1,2,3, OR 4)

CEILING

TRUSS

FINISHED FLOOR
 (0'-0" AFF.)

SPECIFY
 TAKE OFF FROM PLANS
 FIELD CHECK (BUILDING)

PROVIDE

A = _____

B = _____

C = _____

D = _____

E = _____

F = _____

G = _____

H = _____

I = _____

VERIFY OR SUPPLY DIMENSIONS

NAME: _____

FIRM: _____

SIGN: _____

DATE: _____

VERIFY OR SUPPLY DIMENSIONS; INFORMATION SHOULD BE VERIFIED AND/OR SUPPLIED FROM MEASUREMENTS OF CONSTRUCTED BUILDING ONLY. BY SIGNING THIS YOU AGREE THAT ALL INFORMATION IS CORRECT AND ARIZONA COURTLINES, INC. IS TO PROCEED WITH MANUFACTURING.

REVISION/STAGE: MONTH / DAY / YEAR

RELATED DRAWINGS / INFORMATION:

PROJECT: _____

TRUSS HEIGHT & LAYOUT

FC-1.3

THIS DRAWING IS PROPERTY OF ARIZONA COURTLINES, INC. AND MAY NOT BE REPRODUCED WITHOUT WRITTEN PERMISSION

ARIZONA COURTLINES, INC.



8742 NORTH 172ND AVENUE
 PEORIA, ARIZONA 85345
 PHONE (623) 939-8726
 FAX (623) 939-2626
 WWW.ARIZONACOURTLINES.COM

DRAWN BY: EDDIE CARRERATA

CHECKED BY: _____

QUANTITY: _____